



आरोग्यम् परमं सुखम्

**ALL INDIA INSTITUTE OF MEDICAL SCIENCES, DEOGHAR**

**अखिल भारतीय आयुर्विज्ञान संस्थान, देवघर**

INSTITUTE OF NATIONAL IMPORTANCE UNDER MINISTRY OF HEALTH AND FAMILY WELFARE

(स्वास्थ्य और परिवार कल्याण मंत्रालय के अंतर्गत राष्ट्रीय महत्व की संस्थान)

P.T.I., Daburgram, Jasidih, Deoghar, (Jharkhand) - 814142

पी.टी.आई., डाबरग्राम, जसीडीह, देवघर, (झारखंड) - ८१४१४२

Invitation of quotation  
for  
Construction of Rain water shed  
With  
Provision of water supply at desire location  
for  
Mess at AIIMS Deoghar

Reference No.: AIIMS/Deoghar/Mess/Rain water shed/2020-21/35

Date of Issue: 25<sup>th</sup> January, 2020

Last Date of Submission: 09<sup>th</sup> February, 2020 at 04:00 PM.

All India Institute of Medical Sciences, Deoghar

P.T.I. campus, Daburgram, Jasidih, Deoghar: 814142, Jharkhand

email: office.aiimsdeoghar@gmail.com

**Reference no:** AIIMS/Deoghar/Mess/Rain water shed/2020-21/35

## **Invitation of quotation for Construction of Rain Water shed with provision of water supply at desire location at AIIMS Deoghar**

**Sealed Quotations** are invited on behalf AIIMS, Deoghar for Construction of Rain Water shed with provision of water supply at desire location (**Annexure-I**) required for the Mess at AIIMS Deoghar as per terms & conditions mentioned below. The filled quotations along with all the required documents must reach in the office of the undersigned on or before **09.02.2020 at 04:00 PM**. The **Envelope containing the quotation** must be sealed and **super scribed as under:-**

**“QUOTATION FOR CONSTRUCTION OF RAIN WATER SHED WITH PROVISION OF WATER SUPPLY AT DESIRE LOCATION AT AIIMS DEOGHAR FOR MESS ; REFERENCE NO.: AIIMS/Deoghar/Mess/Rain water shed/2020-21/35 DUE ON 09.02.2020 at 04.00 PM”**

**The Quotation should be send to the address:-**

Assistant Procurement Officer  
AIIMS Deoghar PTI Campus,  
Daburgram, Jasidih,  
Deoghar, Jharkhand -814142.

### **1. Terms & Conditions:**

- a) The quotations received **after this deadline or unsealed shall not be entertained** under any circumstances whatsoever. In case of postal delay this Institute will not be responsible. The offer submitted by Fax / email shall not be considered and no correspondence will be entertained in this matter.
- b) Quotations must be in the **enclosed prescribed Performa (Annexure -2) on the letter head of the firm duly signed** by the Proprietor/ Partner/ Director or their authorized representative, In case of signing of quotation by the authorized representative letter of authorization must be attached with the quotation.
- c) The work shall be executed as per direction of the nominated person.
- d) Rates must be quoted in Indian rupees in words and figures.
- e) Rates must be inclusive of **all charges** (including Freight charges, all taxes etc.).
- f) EMD Rs 5000/- (Rs Five Thousand) only in the form Demand Draft in any nationalized bank in the favour of AIIMS Deoghar, payable at Patna shall be submitted with Quotation.
- g) 5% security deposit will be withheld from his first RA bill and shall be released after completion of warranty period.
- h) 12 months warranty period from the date of completion of the satisfactory installation.
- i) **No overwriting or cutting** is permitted in the rate. If found, the quotation shall be summarily rejected.
- j) In case the agency is not started the work within 07 days of issue of the work order then the entire amount of EMD shall be forfeited by AIIMS Deoghar without any notice.
- k) **Total cost/amount will be taken in consideration for L1.** Becoming L1 will not be the criteria for awarding of purchase order unless the rates are reasonable & justified.

- l) The firm / agency may satisfy the following conditions and **attach self-attested copy of the same with the quotation:**
- The firm shall have valid GST / Other taxes and IT PAN.
  - Registration of firm
  - The firm should not be black listed by any Government agency/Department.
  - Work order of any government institute for similar work.
- m) Quotations qualified by such vague and indefinite expressions such as “subject to prior confirmation”, “subject to immediate acceptance” etc. will be treated as vague offers and It will be rejected accordingly. Any conditional quotation shall be rejected summarily.
- n) 5% amount from bill will be deducted as security deposit. It will be refunded within three months after satisfactory performance report submitted by the nominated person/ concern Department, for the equipments/ work.
- o) **Work should be completed within 15 days from the date of issue of work order.**
- p) **Payment Terms:** The payment shall be made after successful competition of the work and after inspection by the AIIMS Deoghar.
- q) **Disputes:** -In the event of any dispute or disagreement arising between the contractors and any other department of AIIMS Deoghar with regards to the interpretation of “Terms & Conditions” of this inquiry, the same shall be referred to arbitrator appointed by The Executive Director, AIIMS, Deoghar, whose decision will be final and binding upon the contractor.
- r) AIIMS Deoghar reserve the right to accept or reject any or all quotations without assigning any reason there of and also does not bind itself to accepted the lowest quotation. AIIMS Deoghar also reserves the rights to accepted all the item in the given NIQ or only part of it in any given schedule without assigning any reason.
- s) No quotation will be accepted if received after due date. The envelope containing quotation should be sealed with WAX/TAPE on both sides.

**Encl.:** Annexure 1 (Specification)

Annexure 2 (Format of price bid)

(Annexure - 1)

Reference no: AIIMS/Deoghar/Mess/Rain water shed/2020-21/35

Work Details						
N/W	Construction of Rain water shade near Mess for washing area with provision of water supply at desired location,at AIIMS Deoghar.					
SLNo	Description	Qty	Unit	Rate	Amount	DSR No. 2016
I	EARTHWORK					2
I.I	Earth work in excavation by mechanical means (Hydraulic excavator) / manual means in foundation trenches or drains (not exceeding 1.5 m in width or 10 sqm on plan), including dressing of sides and ramming of bottoms, lift upto 1.5 m, including getting out the excavated soil and disposal of surplus excavated soil as directed, within a lead of 50 m.					2.8
1.1.1	All kinds of soil.	2.00	cum	166.40	332.80	2.8.1
2	CONCRETE WORK					4
2.1	Providing and laying in position cement concrete of specified grade excluding the cost of centering and shuttering - All work up to plinth level :					4.1
2.1.1	"1:2:4 (1 cement : 2 coarse sand (zone-III) : 4 graded stone aggregate 20 mm nominal size).	1.00	cum	5481.95	5481.95	4.1.3
2.1.2	1:5:10 (1 cement: 5 coarse sand (zone-III): 10 graded stone aggregate 40 mm nominal size).	0.50	cum	4478.15	2239.08	4.1.10
3	ROOFING					12

3.1	Providing and fixing on wall face unplasticised Rigid PVC rain water pipes conforming to JS : 13592 Type A, including jointing with seal ring conforming to IS : 5382, leaving 10 mm gap for thermal expansion, (i) Single socketed pipes.					12.41
3.1.1	75 mm diameter	10.00	metre	148.75	1487.50	12.41.1
4	Providing and fixing on wall face unplasticised - PVC moulded fittings/ <b>accessories</b> for unplasticised Rigid PVC rain water pipes conforming to IS : 13592 Type A, including jointing with seal ring conforming to IS : 5382, leaving 10 mm gap for thermal expansion.					12.42
4.1	Coupler					12.42.1
4.1.1	75mm	1.00	each	64.95	64.95	12.42.1.1
4.2	Single tee with door					12.42.3
4.2.1	75x75x75 mm	2.00	each	121.50	243.00	12.42.3.1
4.3	Bend 87.5°					12.42.5
4.3.1	75 mm bend	4.00	each	76.55	306.20	12.42.5.1
'	Painting with synthetic enamel paint of approved brand and manufacture of required colour to give an even shade :					13.62
5.1	Two or more coats on new work over an under coat of suitable shade with ordinary paint of approved brand and manufacture	20.00	sqm	112.30	2246.00	13.62.1
6	WATER SUPPLY					18
6.1	Providing and fixing Chlorinated Polyvinyl Chloride (CPVC) pipes, having thermal stability for hot & cold water supply including all CPVC plain & brass threaded fittings This includes jointing of pipes & fittings with one step CPVC solvent cement, trenching, refilling & testing of joints complete as per direction of Engineer in Charge.					
6.1.1	20 mm nominal outer dia Pipes	5.00	metre	149.30	746.50	18.9.2
7	Making connection of G.I. distribution branch with G.I. main of following sizes by providing and fixing tee, including cutting and threading the pipe etc. complete :					\ 8.13
7.1	25 to 40 mm nominal bore	1.00	each	394.\5	394.15	18.13.1
8	Providing and fixing gun metal gate valve with C.I. wheel of approved quality (screwed end) :					18.17
8.1	20 mm nominal bore	4.00	each	396.55	1,586.20	18.17.1A
9	Cutting holes up to 30x30 cm in walls including making good the same:					\8.76
9.1	With common burnt clay F.P.S. (non modular) bricks	1.00	each	219.20	219.20	18.76.1
10	Steel work in built up tubular (round, square or rectangular hollow tubes etc.) trusses etc., including cutting, hoisting, fixing in position and applying a priming coat of approved steel primer, including welding and bolted with special shaped washers etc. complete.					

10.1	Hot finished welded type tubes	370.00	kg	90.25	33392.5	10.16.1
1 I	Steel work welded in built up sections/ framed work, including cutting, hoisting, fixing in position and applying a priming coat of approved steel primer using structural steel etc. as required.					
11.1	In gratings, frames, guard bar, ladder, railings, brackets, gates and similar works	200.00	kg	85.95	17190	10.25.2
2	Providing at all heights, levels and locations Aluminium profile industrial troughed sheet of Alloy 1500 / 31000 / 40800 , conforming to IS 1254, IS 737, IS 2676. The sheet shall be fixed using selfdrilling /self tapping SS screws of size 5.5x65 mm with EPDM seal complete upto required pitch in horizontal, vertical or curved surfaces i/c cutting to size and shape where required as per specifications, detail drawings and direction of Engineer-in-Charge. The rate shall be inclusive of all screws, seal, ridge, labour, scaffolding, machinery for fixing and approved sealant where required etc. but excluding the cost of purlins, rafters and <b>trusses</b> .					
12.1	0.71 mm thick, the profile detail width 1044/920 mm, cover width 1000/875 mm.	30.00	sqm	790.3	23709	26.19.1
13	Providing and fixing 15 cm wide, 45 cm overall semi-circular plain G.S. sheet gutter with iron brackets 40x3mm size, bolts, nuts and washers etc., including making necessary connections with rain water pipes complete.					
13.1	0.80 mm thick with zinc coating not less than 275 gm/m	10.00	meter	564.7	5647	12.7.1
Total Amount of DSR Items					95286.03	
Deduct 5% for VAT added on DSR Items					4537.43	
Net Amount of DSR Items					90748.60	
Add 6% for CGST on DSR item					5444.92	
Add 6% for CGST on DSR item					5444.92	
Net Estimated Amount including GST					101638.43	
say ₹					<b>1,01,638</b>	



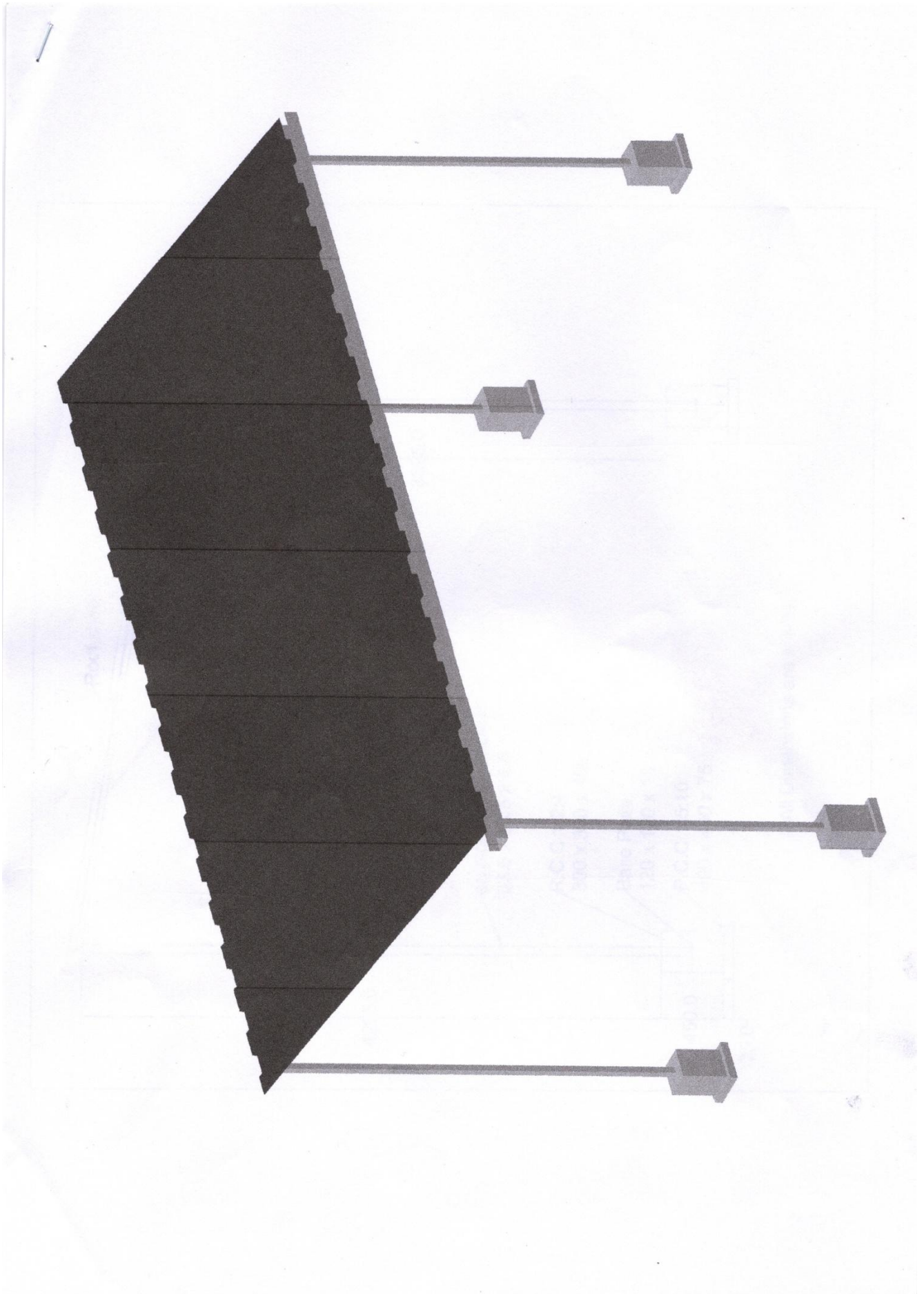



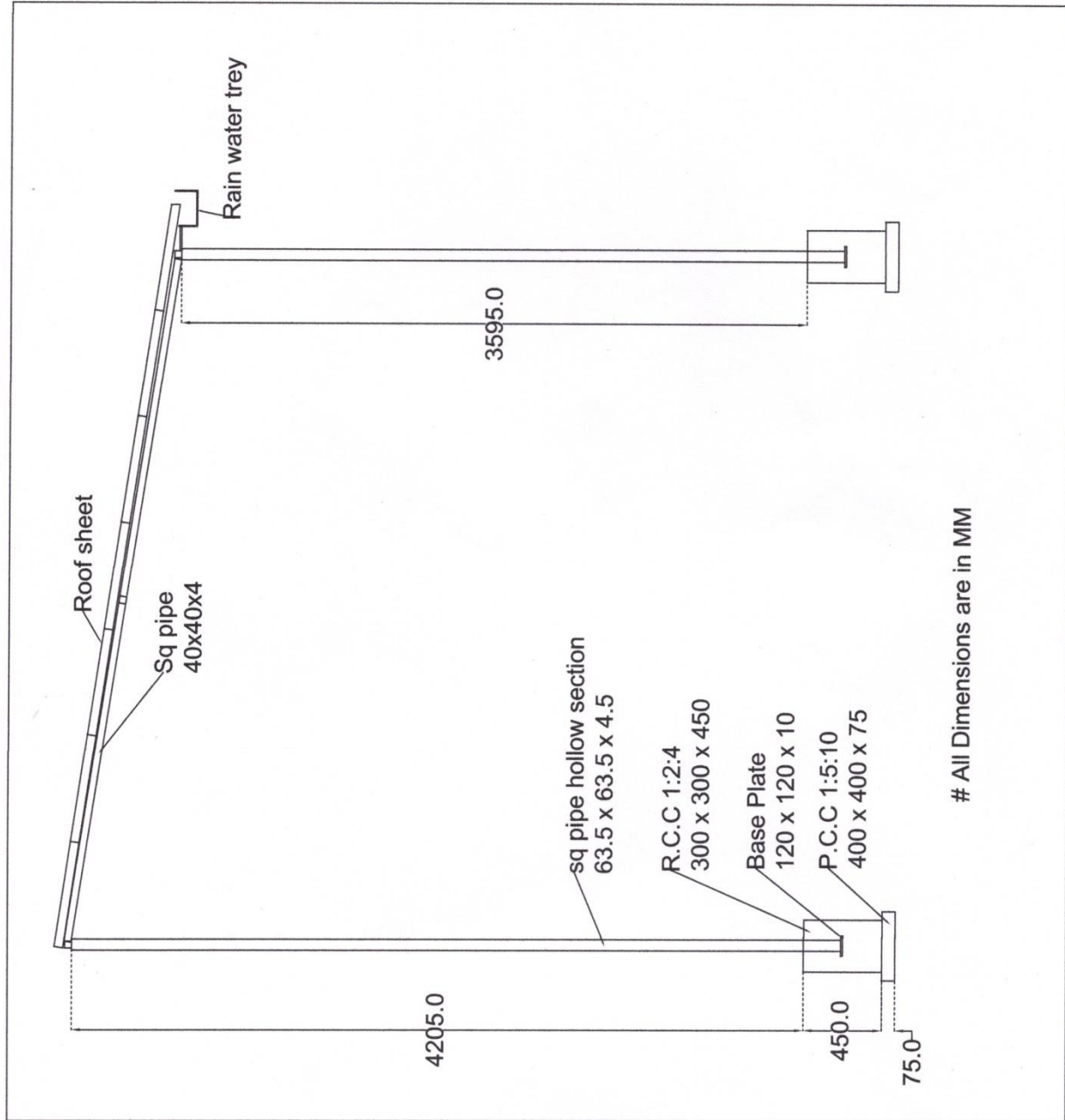

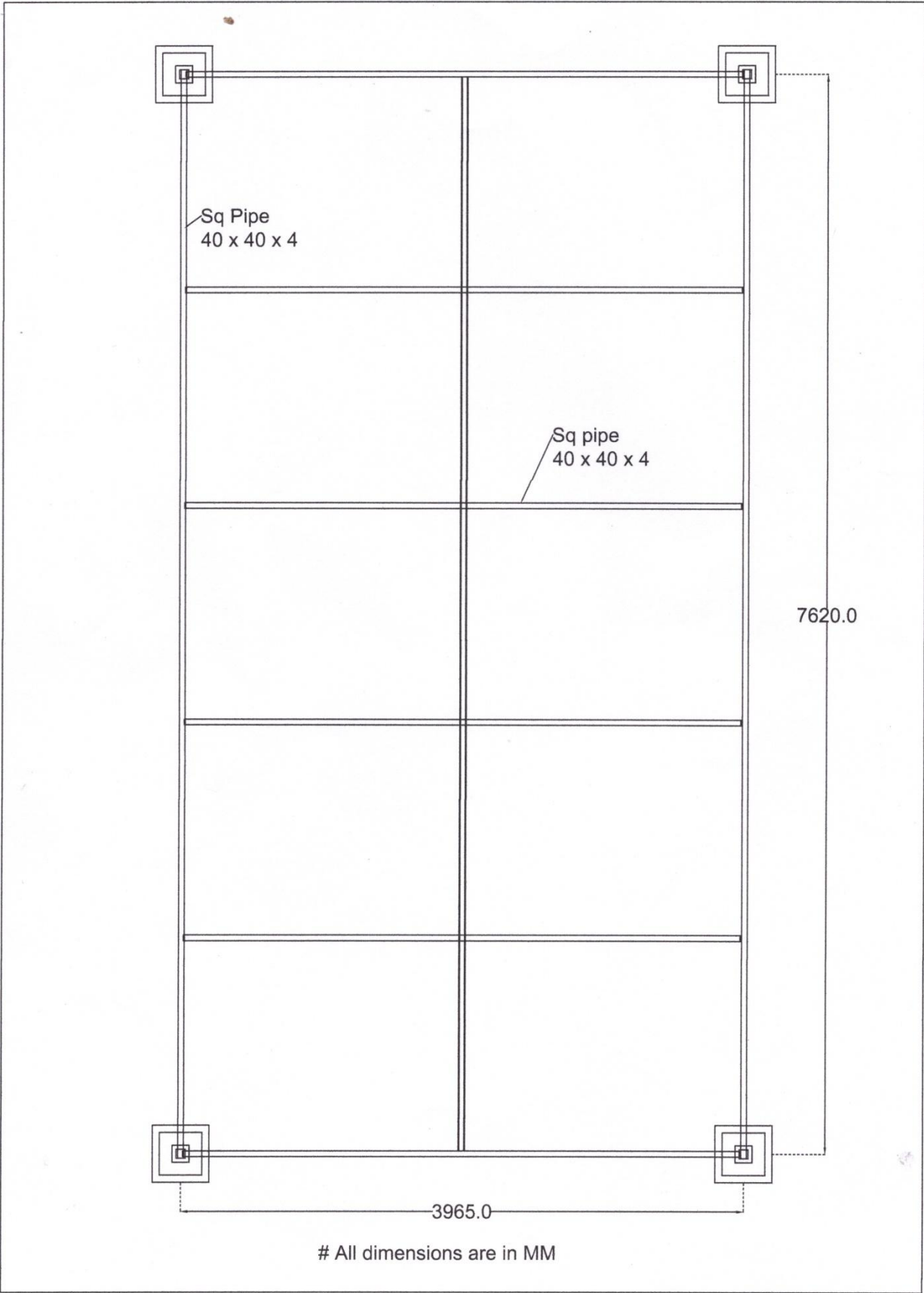

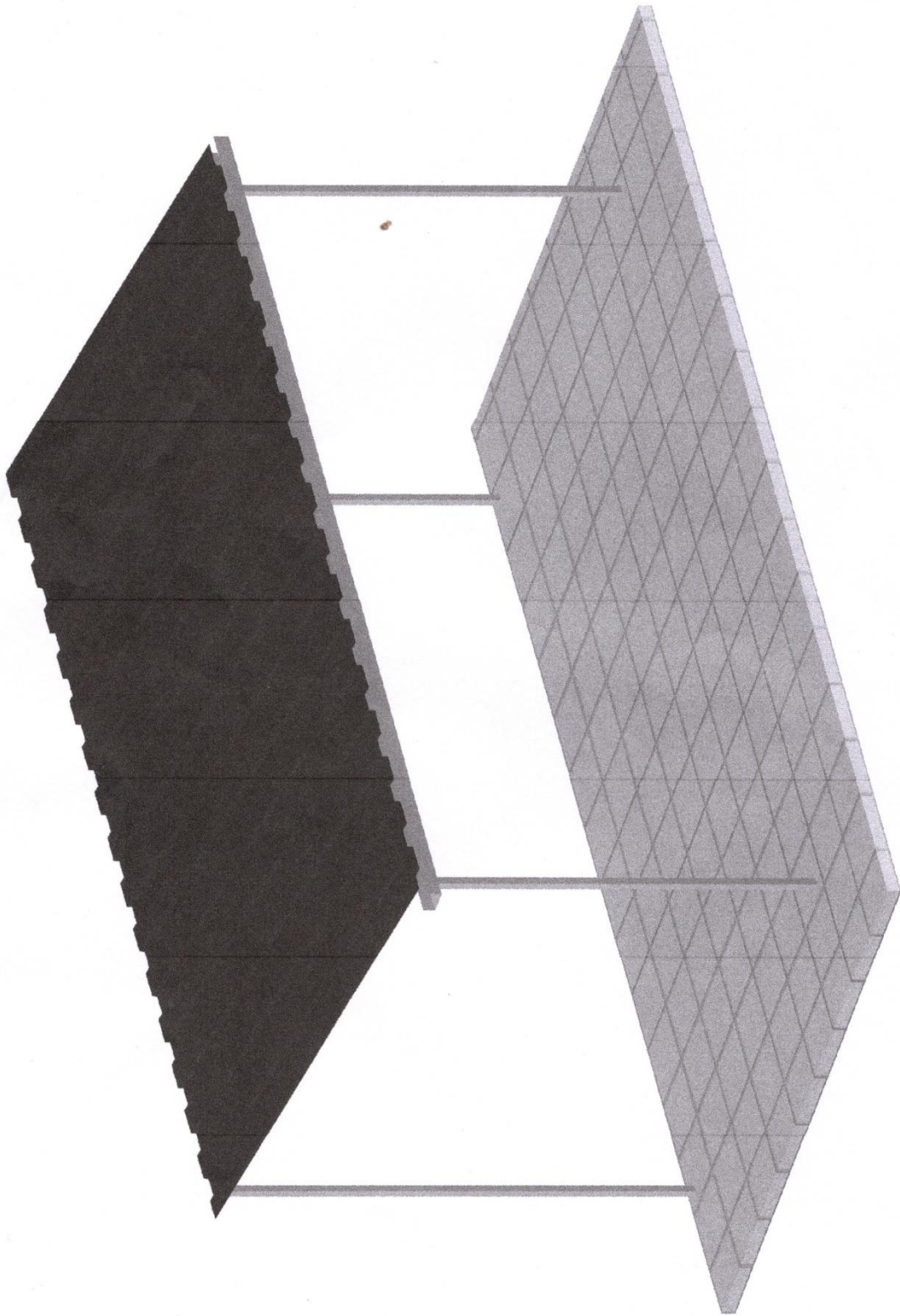

**Reference no:** AIIMS/Deoghar/Mess/Rain water shed/2020-21/35

**[ Letter head of firm ]**

PRICE BID FORM

To,  
Assistant Procurement officer,  
AIIMS, Deoghar.  
Dear Sir,

I/We ..... am/are submitting the quotation for reference "QUOTATION FOR CONSTRUCTION OF RAIN WATER SHED WITH PROVISION OF WATER SUPPLY AT DESIRE LOCATION AT AIIMS DEOGHAR FOR MESS WITH REFERENCE NO.: AIIMS/Deoghar/Mess/Rain water shed/2020-21/35 **DUE ON 09.02.2020 at 04.00 PM**" for Mess at AIIMS Deoghar.

1. I/We have thoroughly examined, understood and accepted terms & conditions given in the enquiry document, failing which my quotation will be rejected out rightly.
2. I/We hereby offer to supply at the following rates:

S. no.	Work done	Qty	Unit	Rate	GST	Total cost
1						
2						
		Total cost/ amount				
Total cost/amount (in words)						

Note:-

- The bidder must quoted their quotation only in above said format on the letter of firm otherwise quotation will be REJECTED.

Date:

(Name):

Place :

Name of Firm/Company/Agency:

GSTIN No.: :

Phone No:

Email:

(Signature of Authorized Person) \_\_\_\_\_

Seal:\_\_\_\_\_